

Φ32 mm brushless motor (high power)

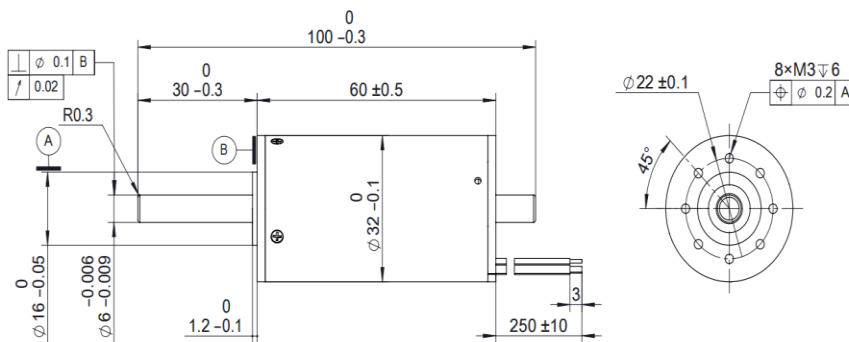

Motor Data		106006004					
Values at nominal voltage 额定电压值							
1	Nominal voltage 额定电压	U_N	24				V
2	No load speed 空载转速	n_0	29000				rpm
3	No load current 空载电流	I_0	900				mA
4	Stall torque 堵转转矩	M_H	1171.2				mNm
5	Stall current 堵转电流	M_I	150.0				A
6	Max. efficiency 最大效率	η_{max}	85				%
7	Nominal power 额定功率	W_N	79.3				W
8	Nominal speed 额定转速	n_N	28030				rpm
9	Nominal torque (max.continuous torque) 额定转矩	M_N	28.3				mNm
10	Nominal current (max.continuous current) 额定电流	I_N	4.5				A
Characteristics 技术参数							
11	Terminal resistance phase to phase 相间电阻	R	0.16				Ω
12	Terminal inductance phase to phase 相间电感	L	31.3				μH
13	Back-EMF constant 反电势常数	K_E	0.82				mV/rpm
14	Torque constant 转矩常数	K_M	7.86				mNm/A
15	Speed constant 转速常数	K_n	1216				rpm/V
16	Current constant 电流常数	K_I	0.127				A/mNm
17	Speed / torque gradient 转速/转矩斜率	$\Delta n/\Delta M$	24.76				rpm/mNm
18	Mechanical time constant 机械时间常数	τ_m	7.1				ms
19	Rotor inertia 转子惯量	J	17.6				gcm^2
Specifications 技术参数							
20	Operating temperature range: 工作温度范围:						
	Motor 电机					-20.....+155	$^{\circ}\text{C}$
	winding, max permissible 线圈最高允许温度					+125	$^{\circ}\text{C}$
21	Direction of rotation 旋转方向					electronically reversible	
22	Max. speed 最大允许转速	n_{max}				32000	rpm
23	Number of pole pairs 磁极对数					125	
24	Number of phases 相数					3	
25	Magnet material 磁钢材料					NdFeB	
26	Hall sensors 霍尔传感器						
Mechanical data 机械参数							
27	Bearing type 轴承类型					ball bearings, preloaded	
28	Axial play 轴向间隙					0 - 0.3	mm
29	Max. axial load (dynamic) 最大轴向载荷 (动态)					6	N
30	Max. force for press fits (static) 最大轴向压配合力 (静态)					90	N
	(static, shaft supported) (静态, 支撑轴)					1200	N
31	Max. radial loading, 5 mm from flange 最大径向载荷					28	N
Product 产品							
32	Weight of motor 重量		258				g

Dimensional drawing 尺寸图



Option, cable and connection information 选件, 电缆和连接信息

Connection Motor (Cable AWG20)

Motor winding A	red	Vhall 4.5V.....24V	red
Motor winding B	black	GND	black

Note: About the torque curves, please contact us for more information.

Motor winding C		yellow
-----------------	--	--------

Hall sensors A		blue
Hall sensors B		green
Hall sensors C		white